

INSTALLATION INSTRUCTION KIT

NEW PULL TO PUSH DRAIN ASSEMBLY (FLAT STYLE)

This Kit Is For **New Flat Style Drains** Manufactured After Jan. 1, 1998 Approx.

1. REMOVE EXISTING VALVE ASSEMBLY AND GASKET.
2. REPLACE WITH NEW DRAIN ASSEMBLY (ITEM 1).
3. USE THE NEW GASKET (ITEM 2) PROVIDED IN THIS KIT.

*OLD STYLE DRAINS USE KIT # 705-332-18

NOTE: OLD STYLE DRAINS HAVE A *CONCAVE BOTTOM*

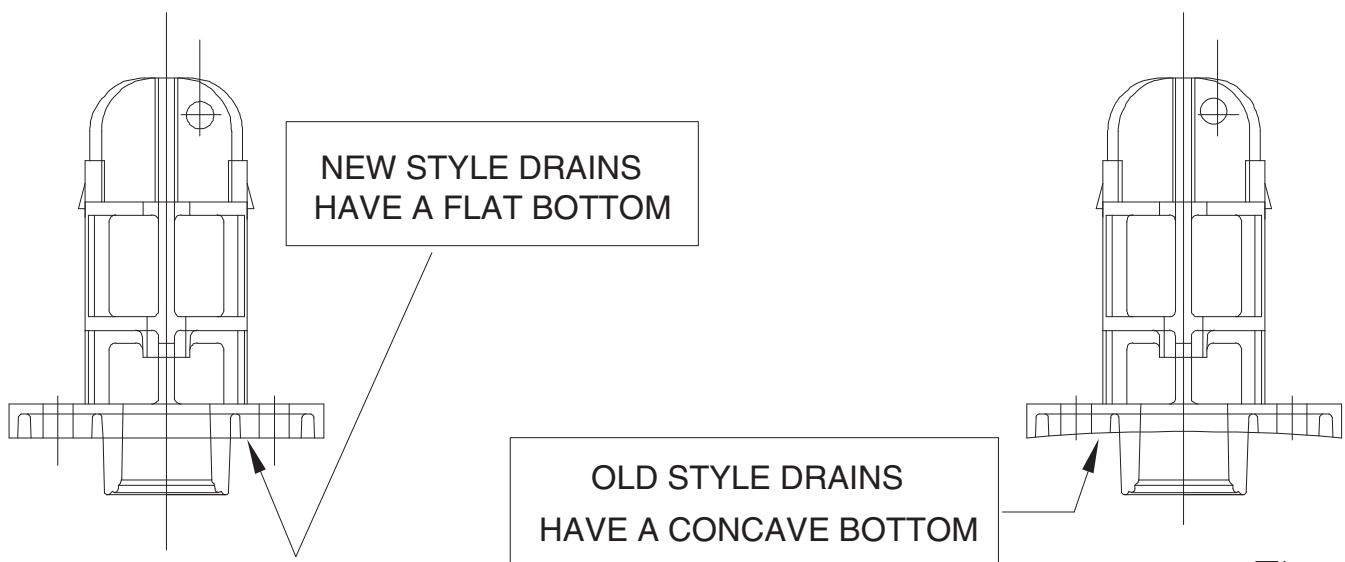
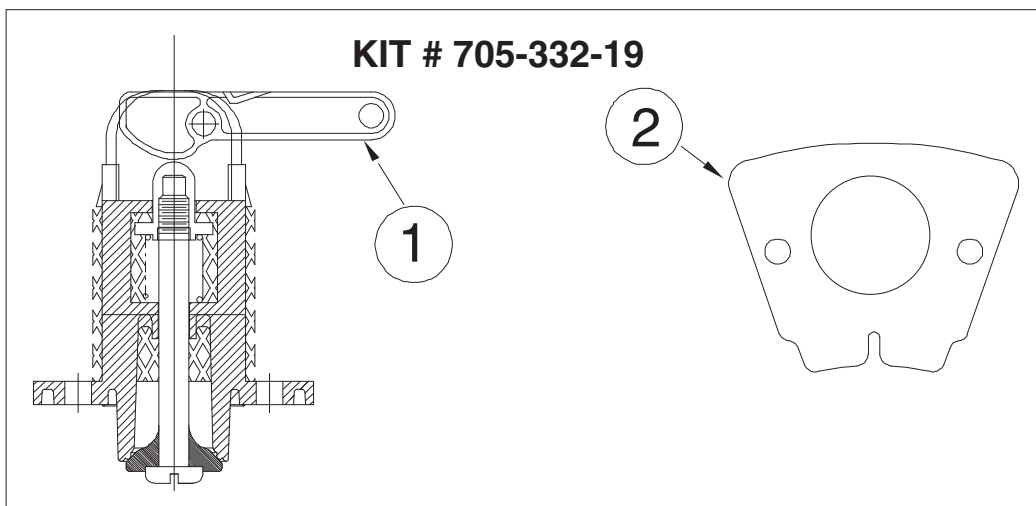

Franklin Fueling Systems

3760 Marsh Road Madison, WI 53718 U.S.A.

Tel: +1 608 838 8786 Fax: +1 608 838 6433 www.franklinfueling.com

Tel: USA & Canada 1 800 225 9787 Tel: Mexico 001 800 738 7610