

# INSTALLATION INSTRUCTIONS

## 705-337-19 Kit Valve Replacement

### NEW PULL TO PUSH DRAIN ASSEMBLY (VAPOR TIGHT STYLE)

This Kit Is For **New Vapor Tight Drains** Manufactured After March 1, 2001  
For **C.A.R.B. Approved Spill Containers- All Models with Drain Valves**

1. REMOVE EXISTING VALVE ASSEMBLY AND GASKET.
2. REPLACE WITH NEW DRAIN ASSEMBLY (ITEM 1).
3. USE THE NEW GASKET (ITEM 2) PROVIDED IN THIS KIT.

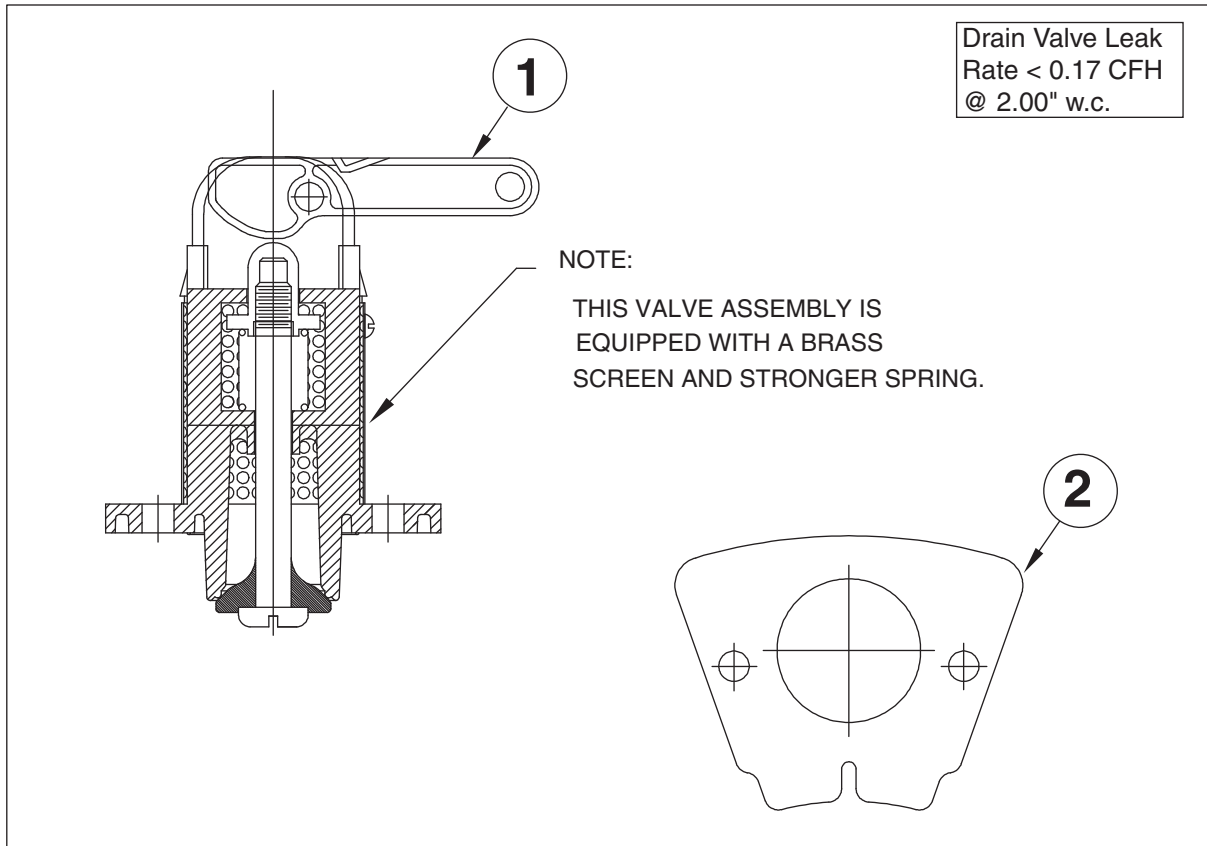

**Torque 1/4" x 20 screws to 50 - 75 in. lb. torque. Use a suitable torque wrench and a 5/32" hex driver.**



**Franklin Fueling Systems**

3760 Marsh Road • Madison, WI 53718 U.S.A.

Tel: +1 608 838 8786 • Fax: +1 608 838 6433 • [www.franklinfueling.com](http://www.franklinfueling.com)

Tel: USA & Canada 1 800 225 9787 • Tel: México 001 800 738 7610

