

90050 Repair Kit

Bottom Loader w/ Sight Glass

Installation Instructions

1. Place flow indicator balls (item 6) in fuel bowl.
2. Place O-ring (item 5) in groove.
3. Align sight window (item 4) with bottom loader as shown below. (Bottom loader not provided in kit).
4. Align reinforcement plate (Item 3) with sight glass.
5. Place fasteners & washers (items 1&2) through holes in reinforcement & sight glass.
6. Thread fastener into bottom loader casting.
7. Tighten securely applying an equal amount of torque to each fastener.

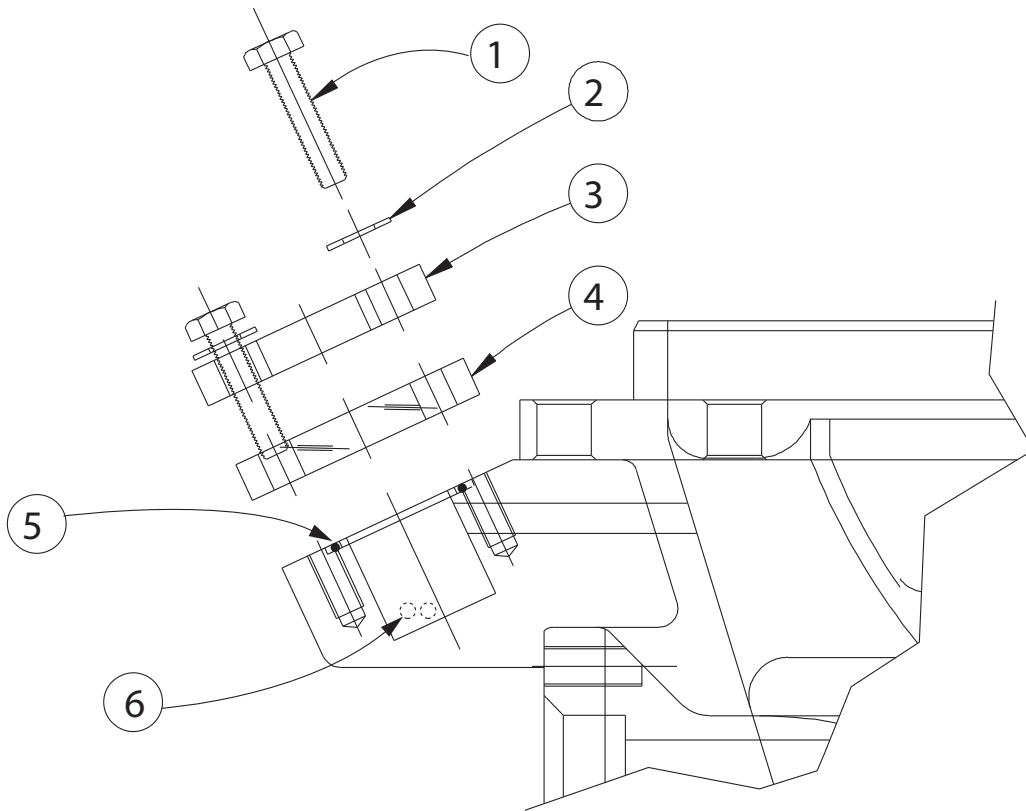

Item	Description	Part Number	Quantity
1	Hex Head Cap Screw #10-24 UNC X .88	11176-36	4
2	Lock-Washer, Internal Tooth	11163-03	4
3	Sight Glass Reinforcement	881-157-01	1
4	Sight Window	880-114-01	1
5	O-Ring	11039-22	1
6	Ball, Flow Indicator	880-124-02	2



3760 Marsh Road
 Madison, WI 53718, U.S.A.
 Tel: +1 608 838 8786
 Tel: USA & Canada 1 800 225 9787
 Tel: Mexico 001 800 738 7610
www.franklinfueling.com